

## 50/980

Beton Altı Trapez Kompozit Döşeme Hadve Yüksekliği 50mm ; Kapatma Eni : 980mm

50/980 Beton Altı Trapez Sac

Groupenerji.com

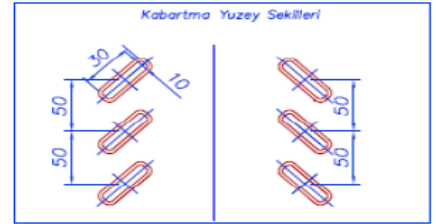
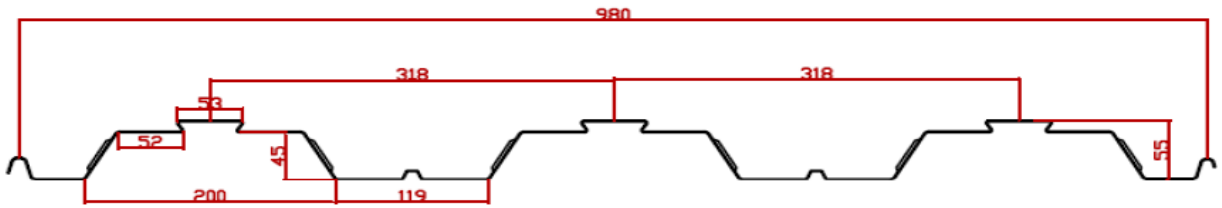

Hadve Yüksekliği: 50mm  
Kapatma eni: 980mm



## 70/915

Beton Altı Trapez Kompozit Döşeme Hadve Yüksekliği 70mm ; Kapatma Eni : 915mm

70/915 Beton Altı Trapez Sac

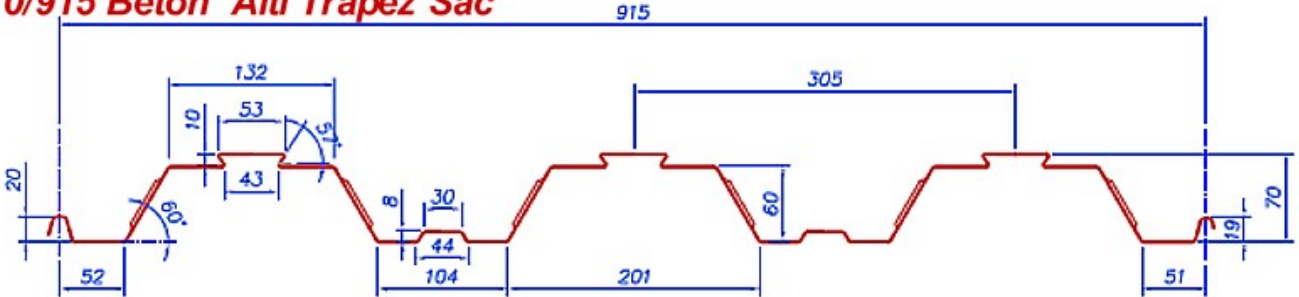

t = 0,70 - 1,25mm



Hadve Yüksekliği: 70mm  
Kapatma eni: 915mm

Groupenerji.com